

LATEST NEWS

Information on the latest happenings at Opuspod and in the community.

TAB BAR

Global navigation appears in the tab bar. Tab bar menu items include: Home, Drop-in, Rent Space, Cafe+Lounge and Account. Appropriate icons will be chosen to replace shapes in tab bar.

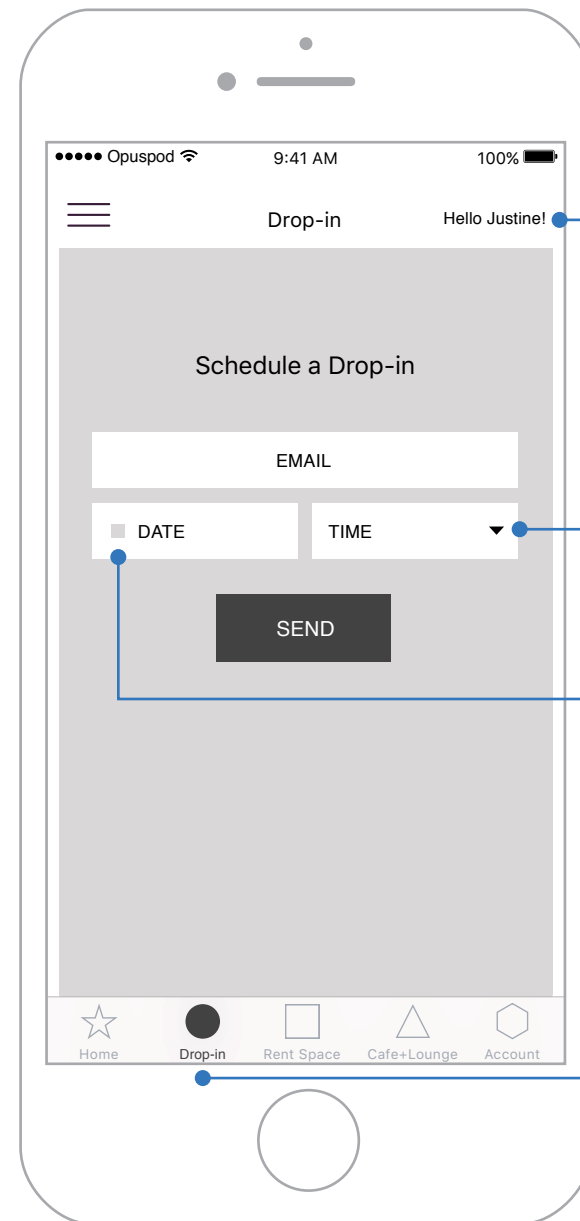

MEMBER LOGIN
Once a user has logged in a small greeting will appear.

TIME
Drop down menu displays available times to schedule a 'Drop-in'.

CALENDAR
Once clicked on the calendar will pop-up from above the tab bar.

DROP-IN
When a menu item is clicked on it will be highlighted in the active link colour.

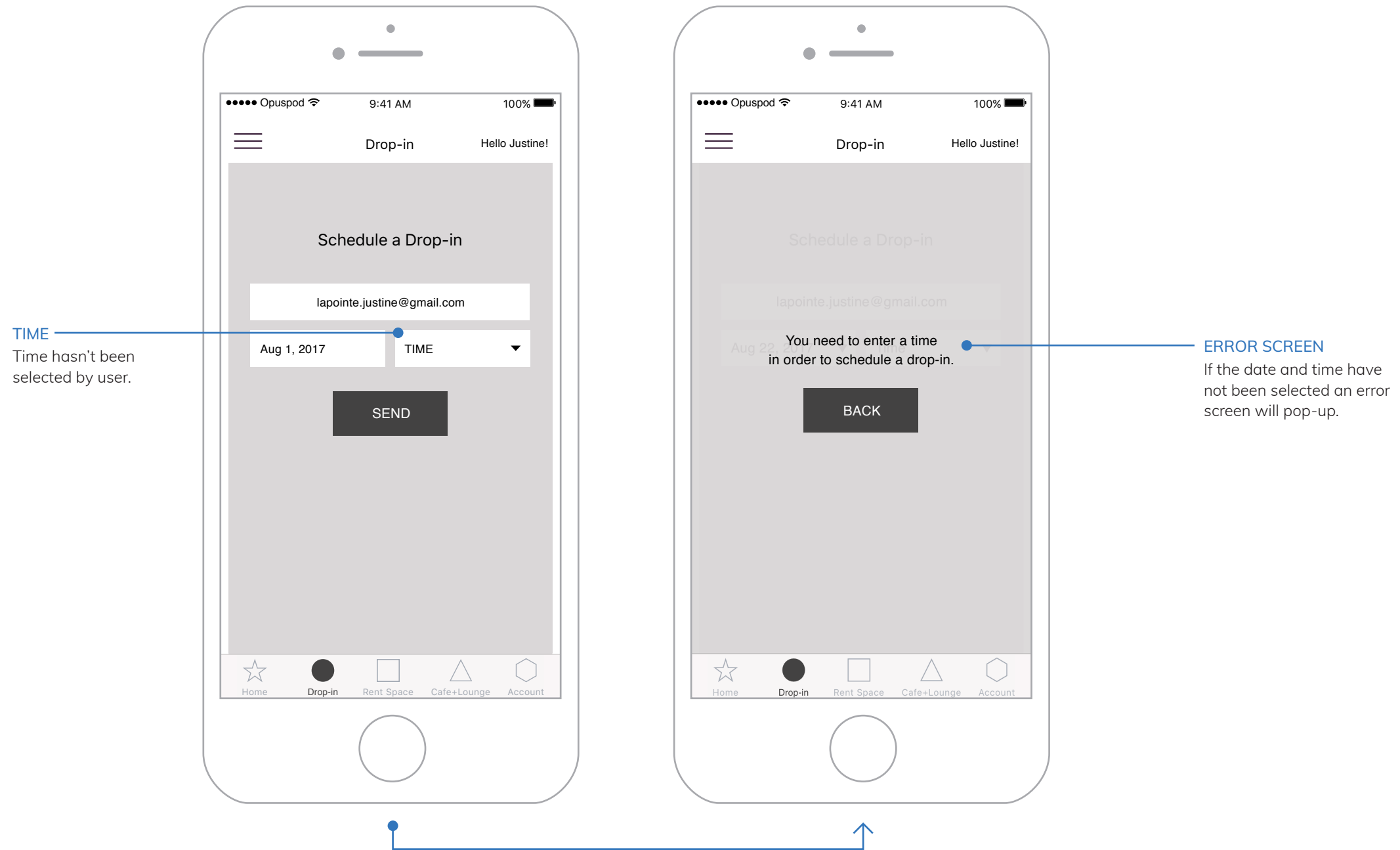

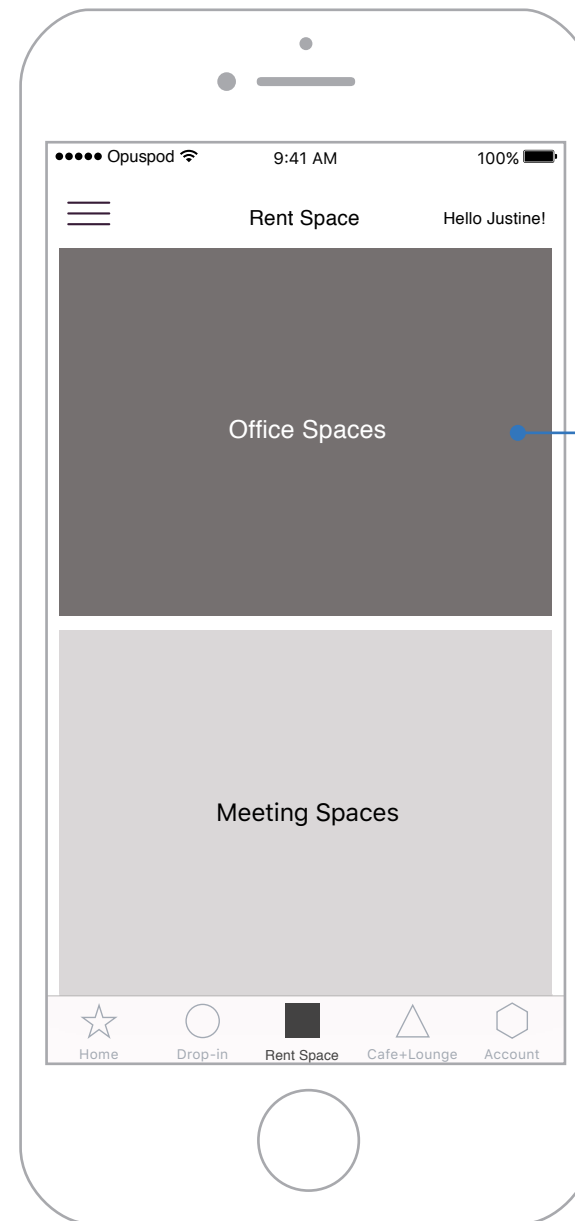

OFFICE SPACES

An image will appear in place of the placeholder grey square. Once clicked on it will take the user to the collection of 'Office Spaces'.

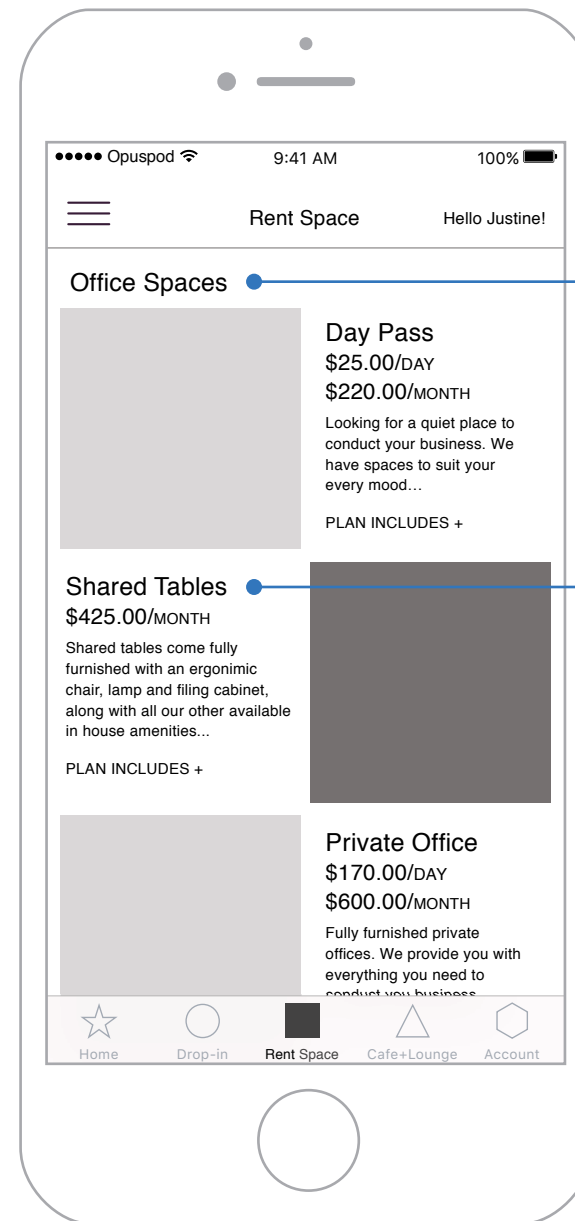

OFFICE SPACES

A list of 'Office Spaces' will appear on this page. They will be accompanied by pricing details and a brief description.

SHARED TABLES

Once clicked on the selected will be highlighted in the active link colour. The user will be redirected to a pdp.

IMAGE PLACEHOLDER
Thumbnail images will display the types of tables offered. A user will be able to expand images.

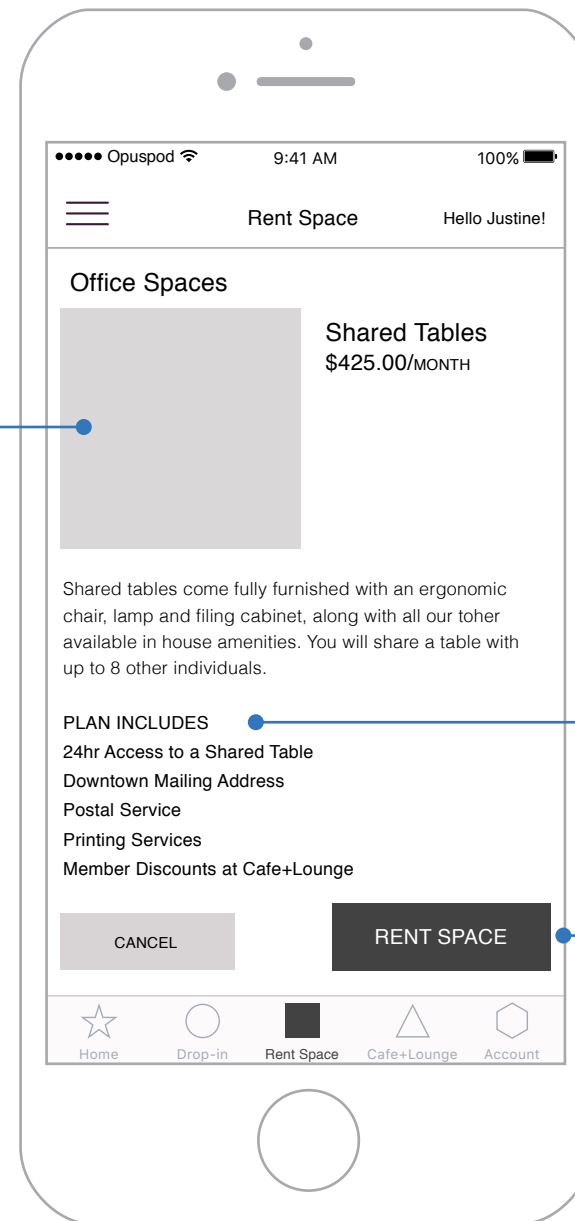

PLAN INCLUDES
Full details on what a plan will include.

RENT SPACE
Large buttons to incite action. When clicked on a user will be taken to a collections page.

IMAGE PLACEHOLDER

Thumbnail images will display the types of tables offered. A user will be able to expand images.

SHARED TABLE DETAILS

The name of the 'Shared Table' and where it is located will be displayed here.

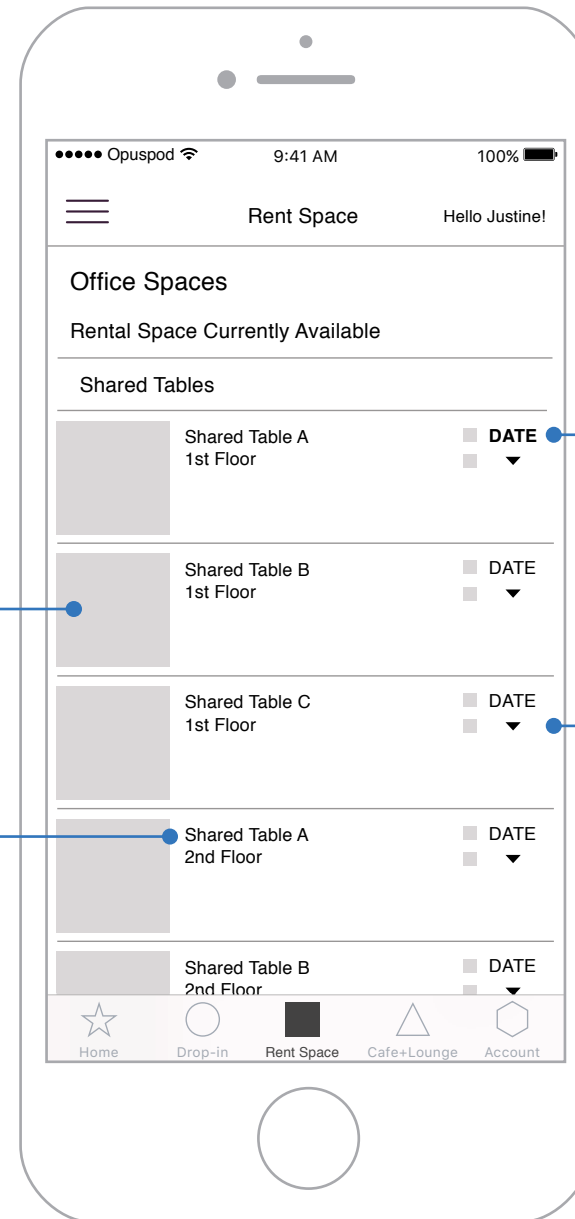

CALENDAR

In order to proceed with renting a space a user will need to select which shared table suits their needs. A user then selects from the 'Date' link available dates in a calendar pop-up. The grey square is a placeholder for a calendar icon.

PICKER

A user must select from the picker the number of people occupying a shared table. The grey square will be an icon of people.

CALENDAR
Calendar pop-up from above tab bar. An arrow is used to move forward through months. One month is automatically selected for Shared Tables.

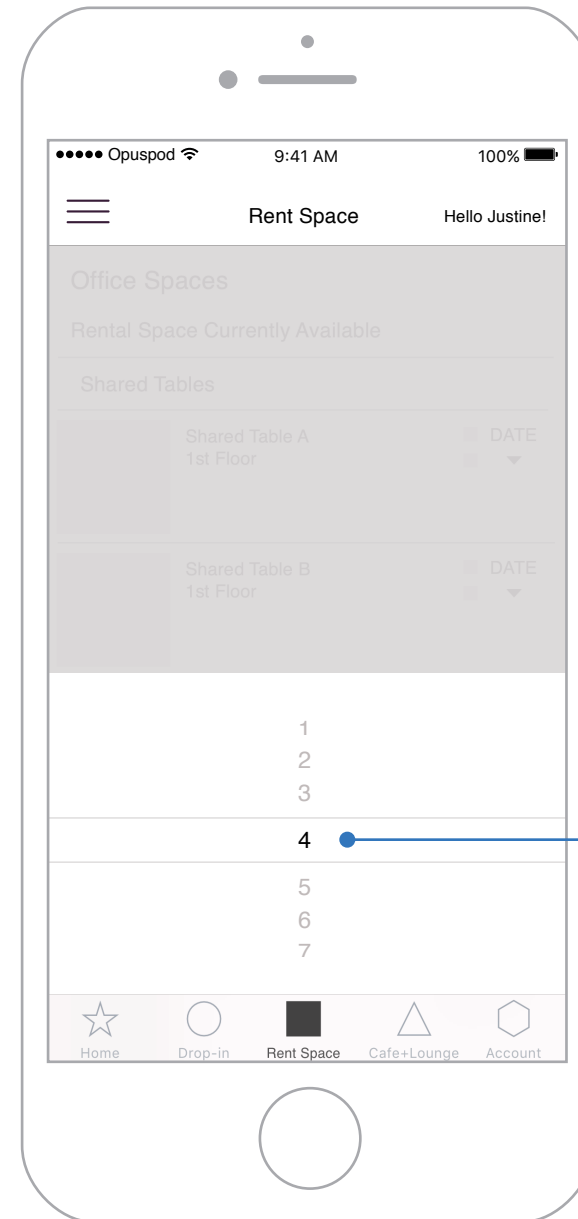
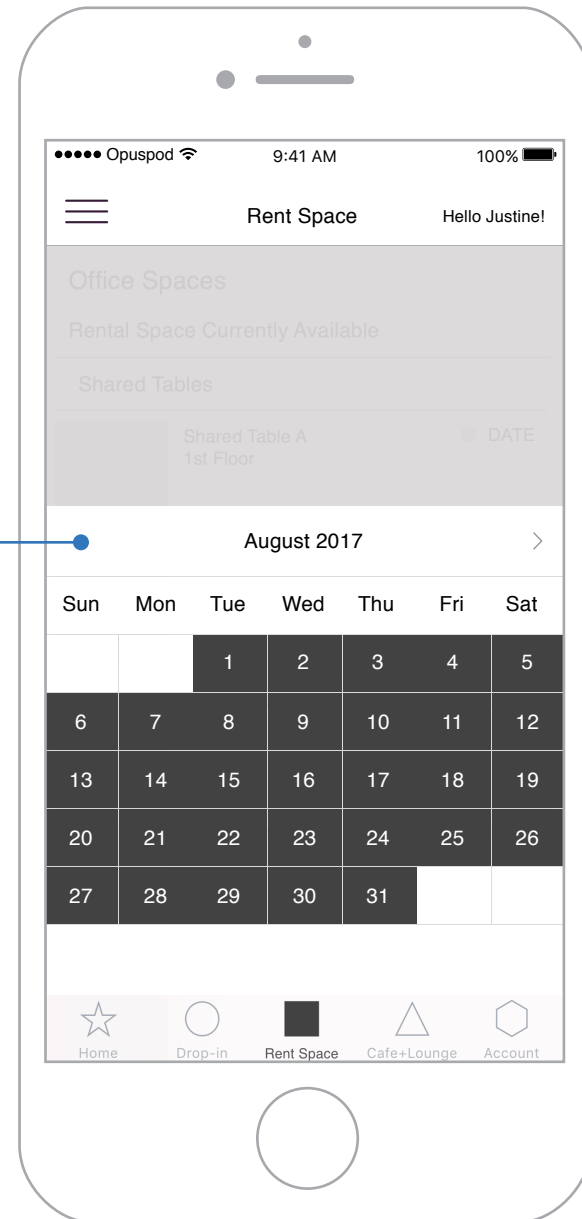

PICKER
A user will be able to choose the available number of seats shown in the picker.

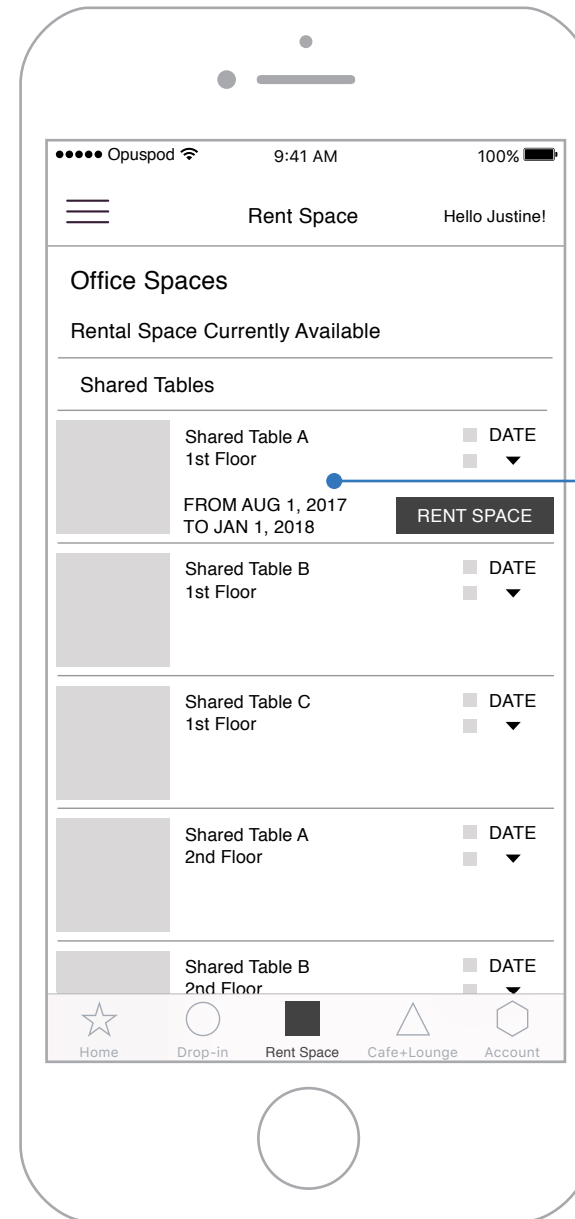

DATES

Once dates selected in the calendar they will appear here. A user can then proceed by clicking on the 'Rent Space' button.

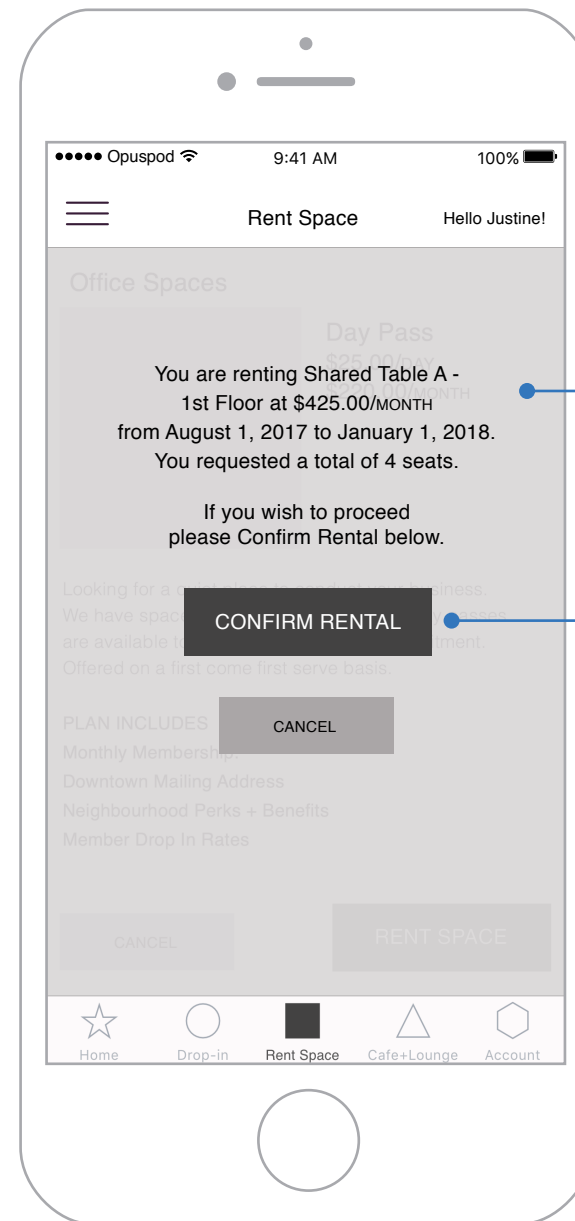

RENTAL DETAILS

Rental details will appear here. A user then chooses if they would like to proceed by clicking on 'Confirm Rental'. Charges will be applied to a members account.

CONFIRM RENTAL

Once a rental is confirmed by the user the transaction will occur.

SELECTING DATES

If a user selects dates too close together an error message will pop up notifying the user they must revise their date selection.

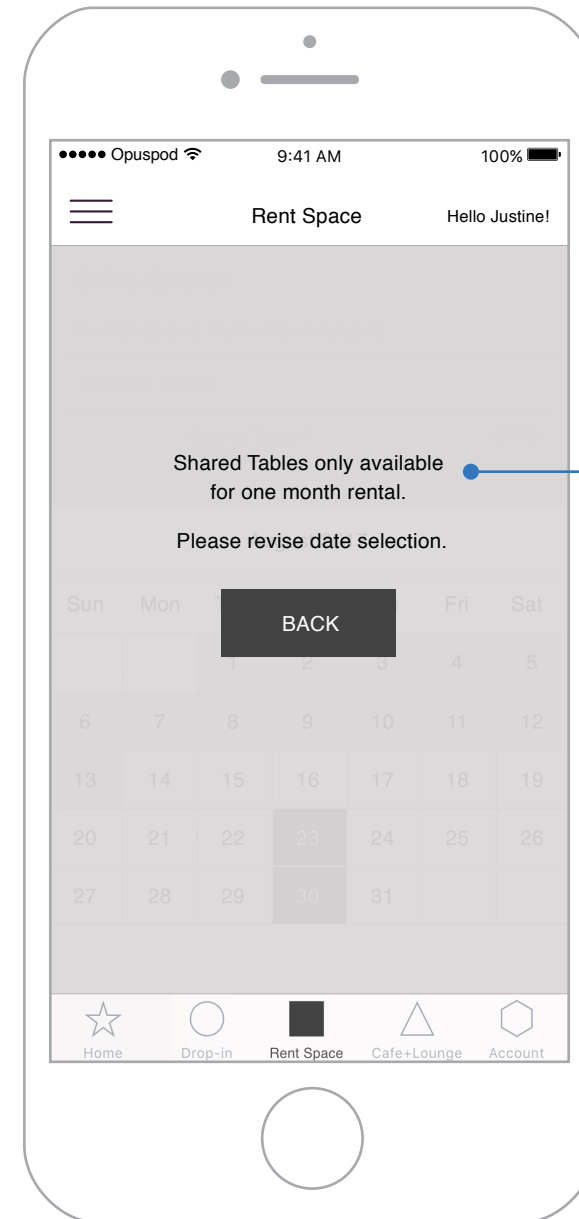
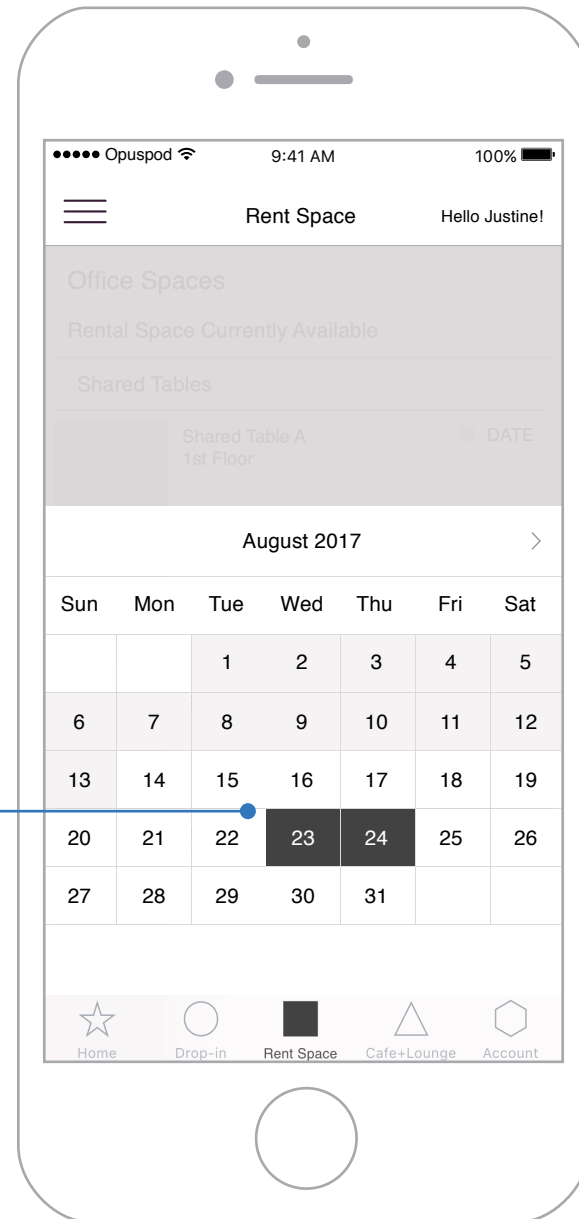

DATE SELECTION ERROR MESSAGE

If a user selects dates that do not span the desired time frame an error message will pop-up. It will then redirect a user to revise their date selection to span one month.

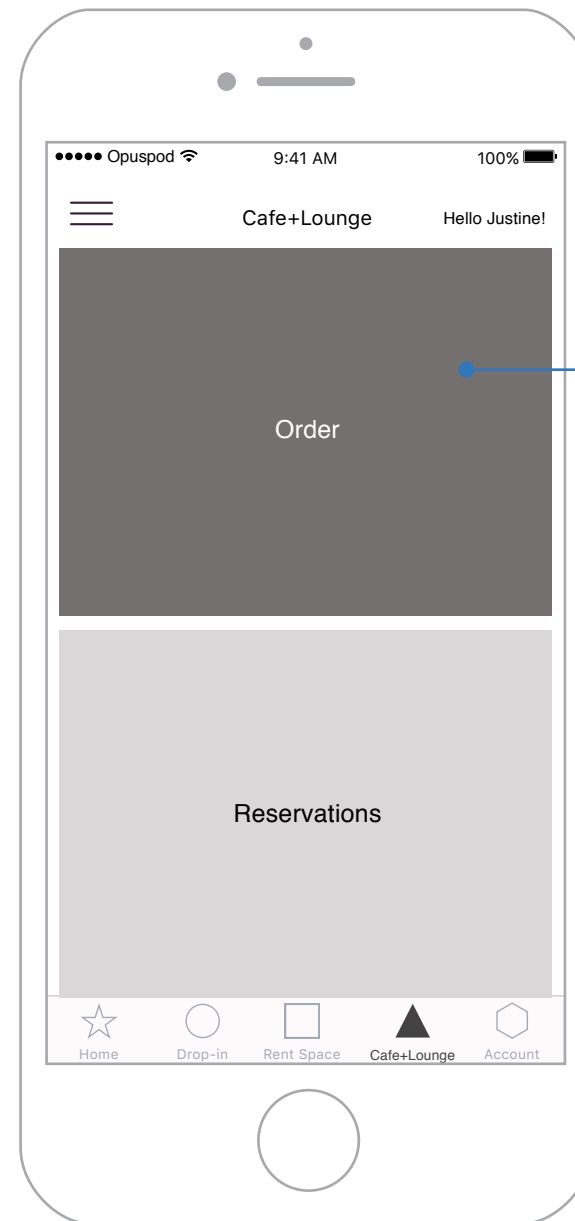

ORDER

Images will replace grey placeholder boxes. Once clicked on it will take users to the 'Order' menu page where users can order from the 'Cafe+Lounge'.

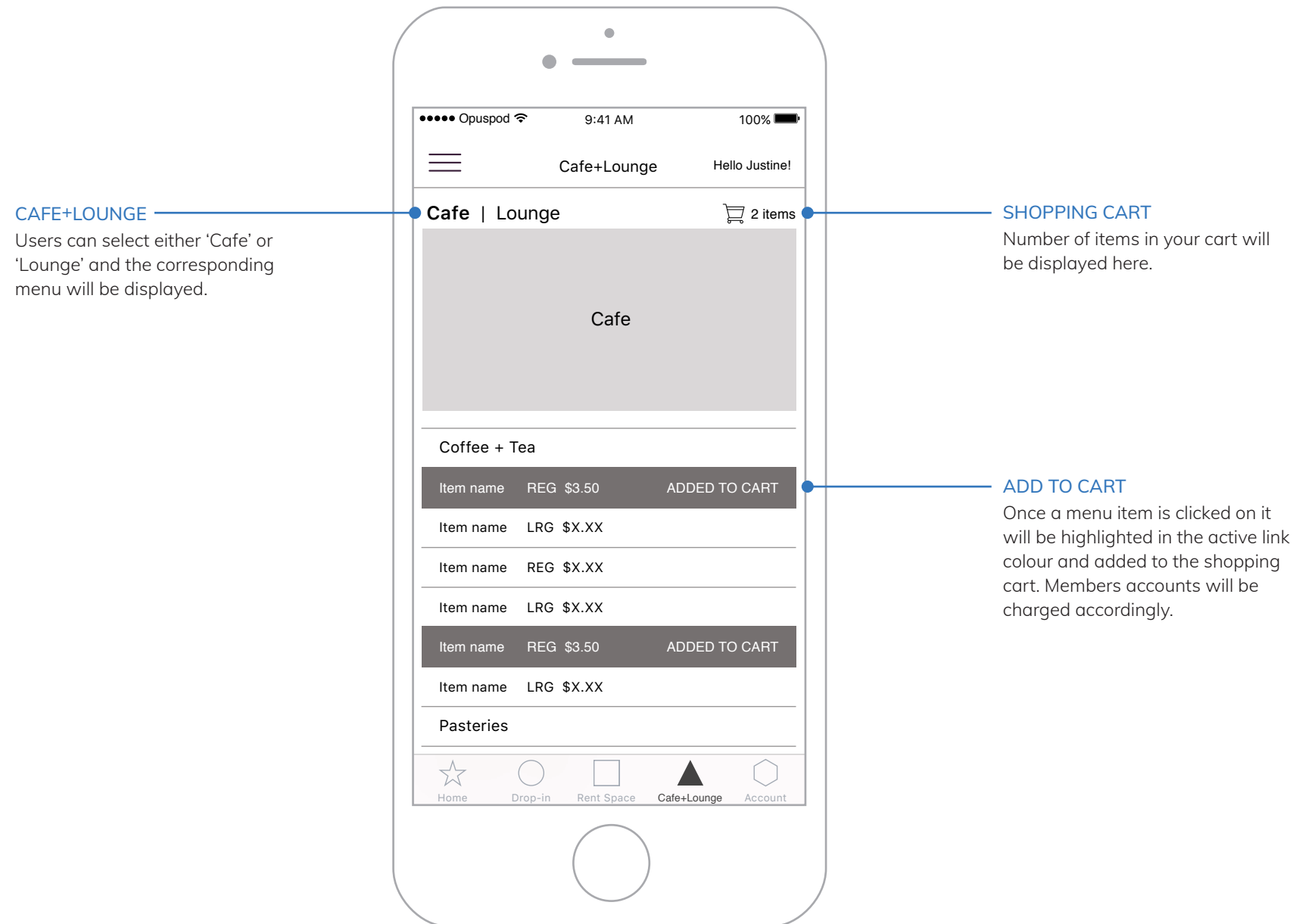

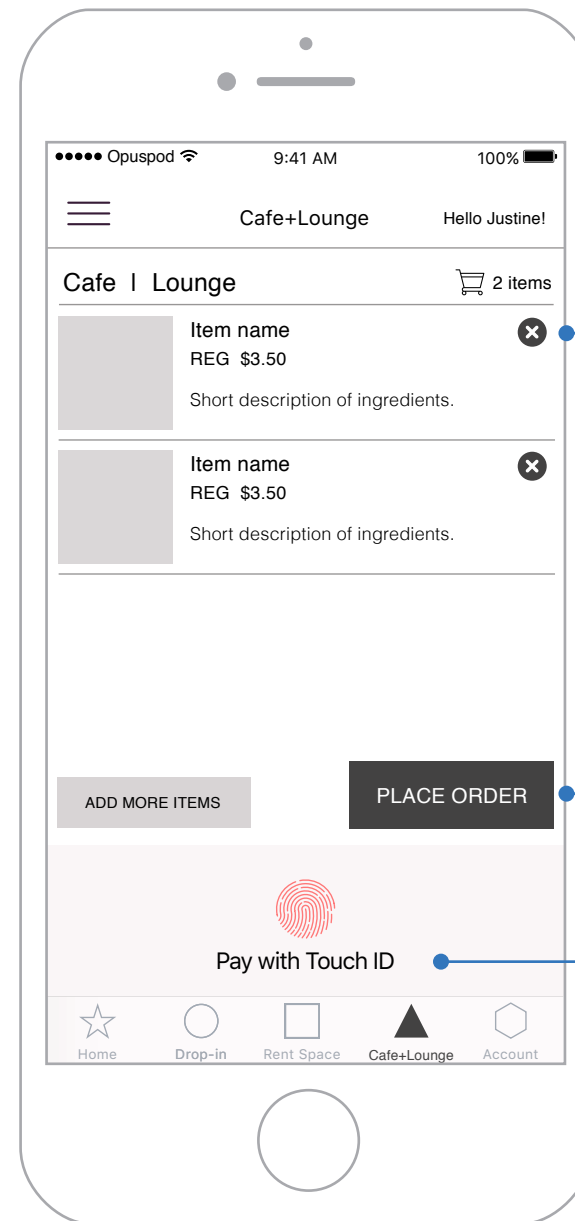

REMOVE ITEM
If a user has added an item by mistake or they no longer wish to purchase it they can remove it by clicking on the 'X' button.

PLACE ORDER
A user can place their order at the Cafe and fast track past the line when picking it up.

PAY WITH TOUCH ID
iPhone users can pay with Touch ID.

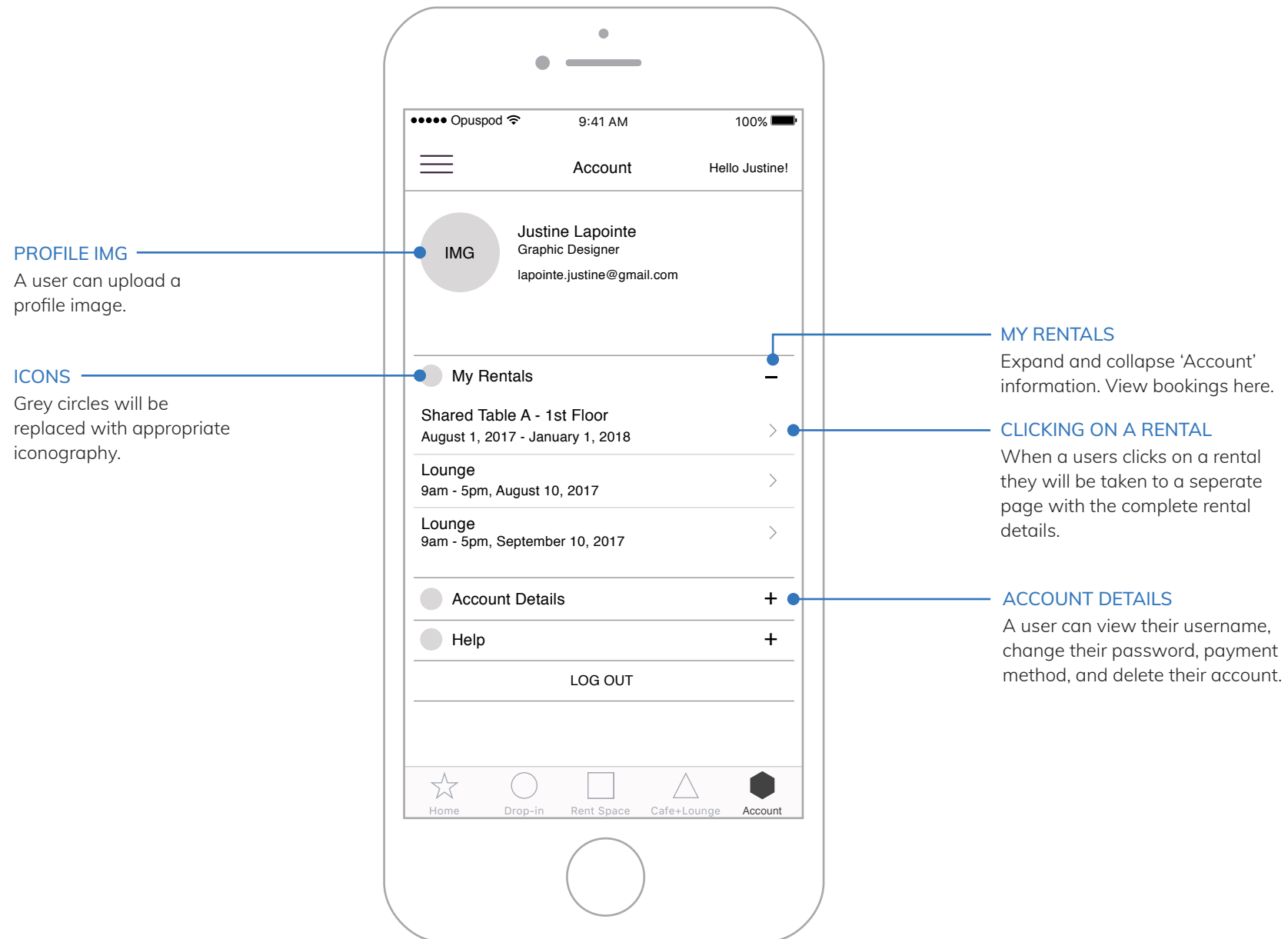

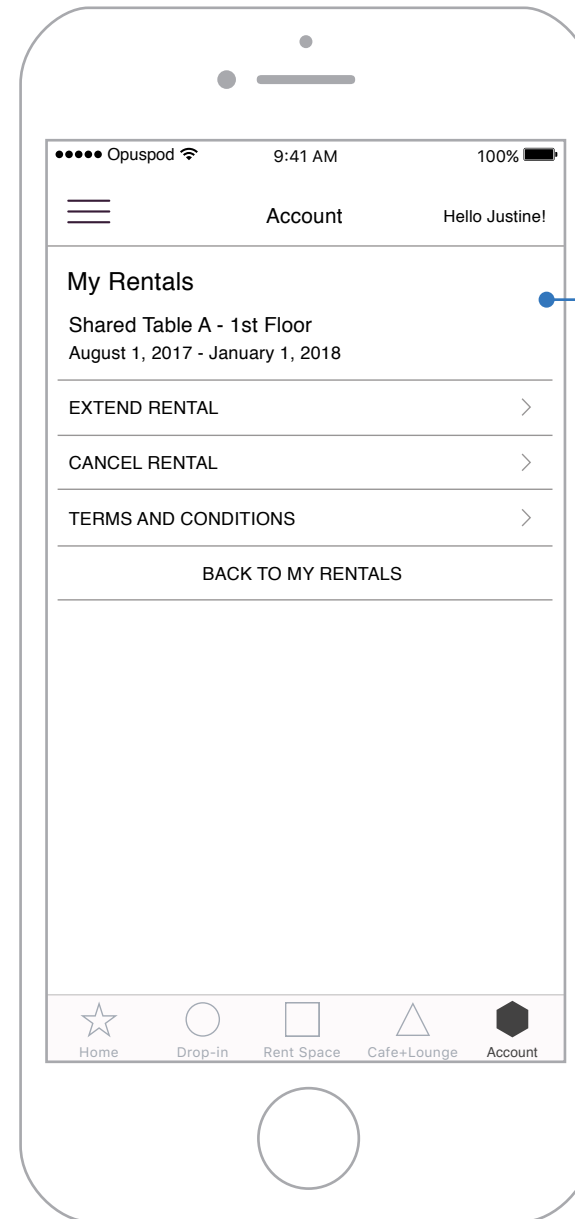

EDIT RENTAL DETAILS

A user can edit their rental details here by choosing to Extend Rental, Cancel Rental, and review Terms and Conditions.

HAMBURGER MENU
When a user clicks on the hamburger menu a sidebar menu will be displayed.

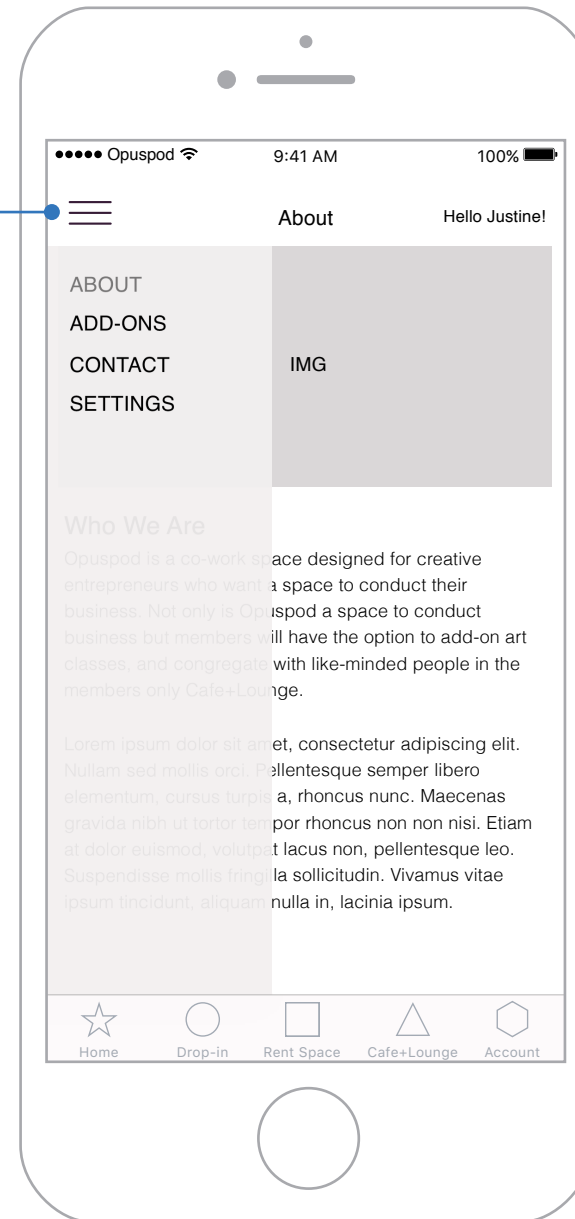

ADD-ONS — A user can choose to click on 'Add-Ons' without expanding the menu item. When a user clicks on the plus sign a full list of add-ons will be displayed.

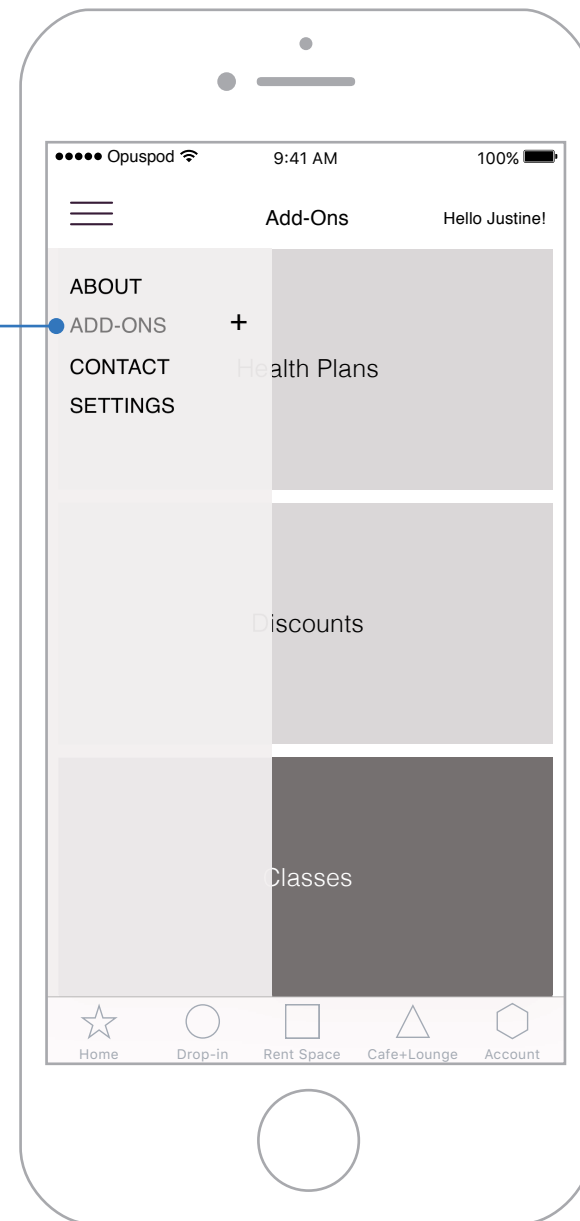

ADD-ONS
The full list of menu items
under 'Add-Ons' is displayed.
When a user clicks on a
menu item they will be taken
to that page.

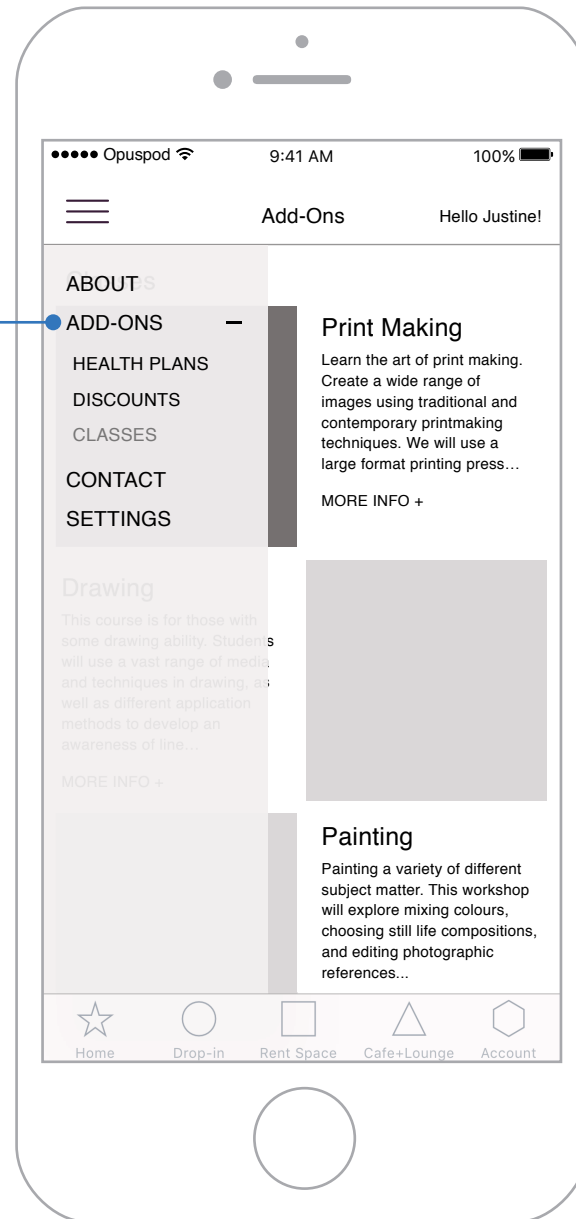

COURSE DATES
A list of course dates will be displayed here. The same formatting applies for Health Plans, Discounts and Classes.

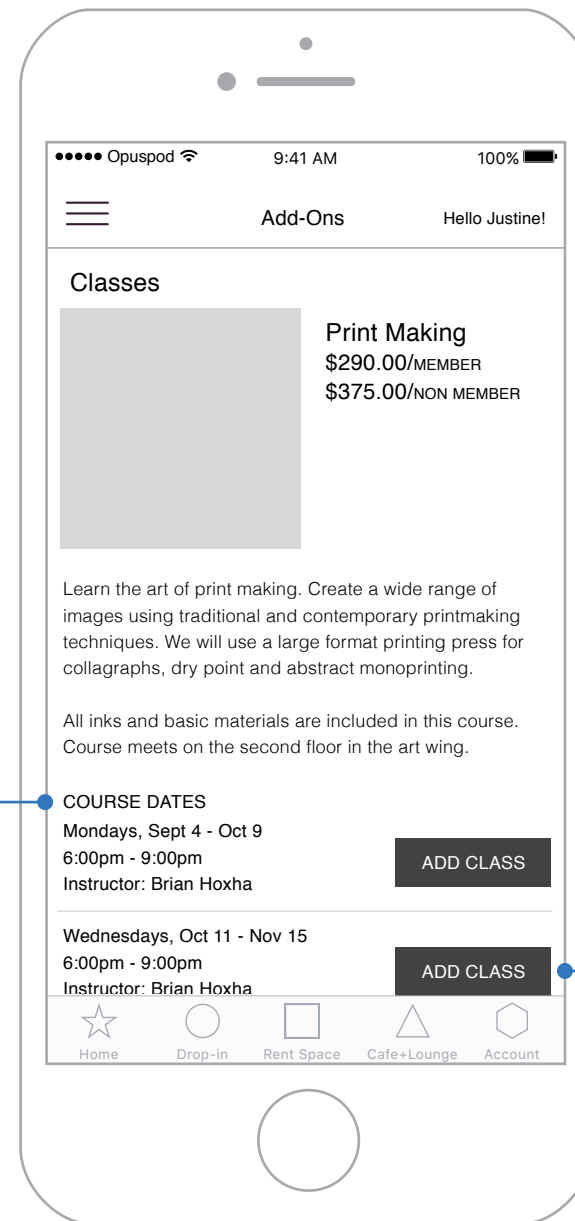

ADD CLASS
Once a user clicks on 'Add Class' member pricing will be applied to a members account.

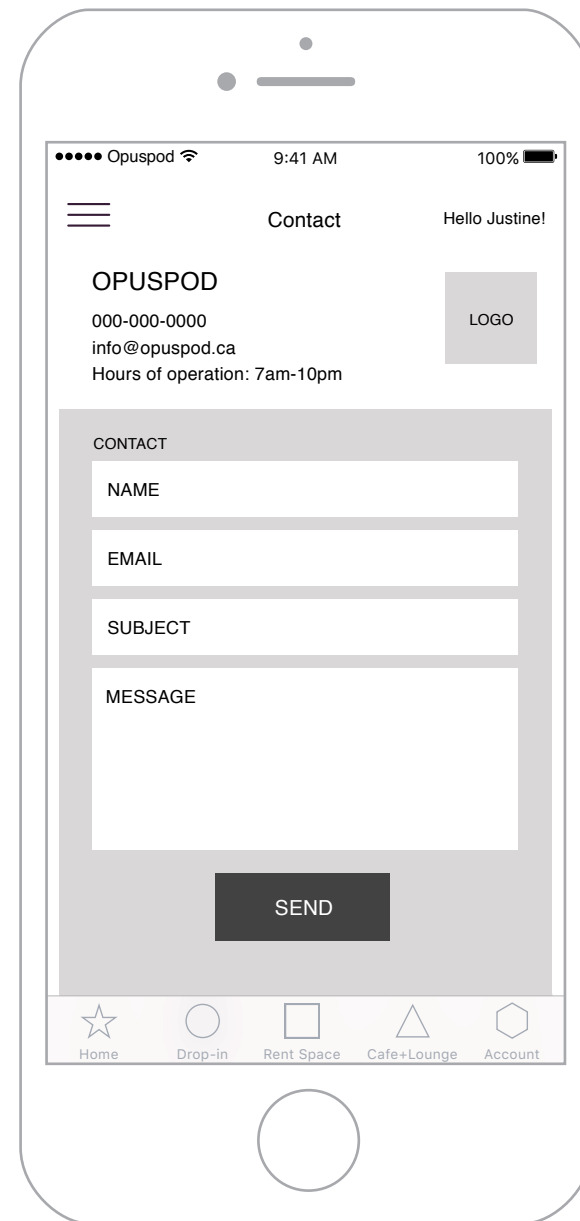

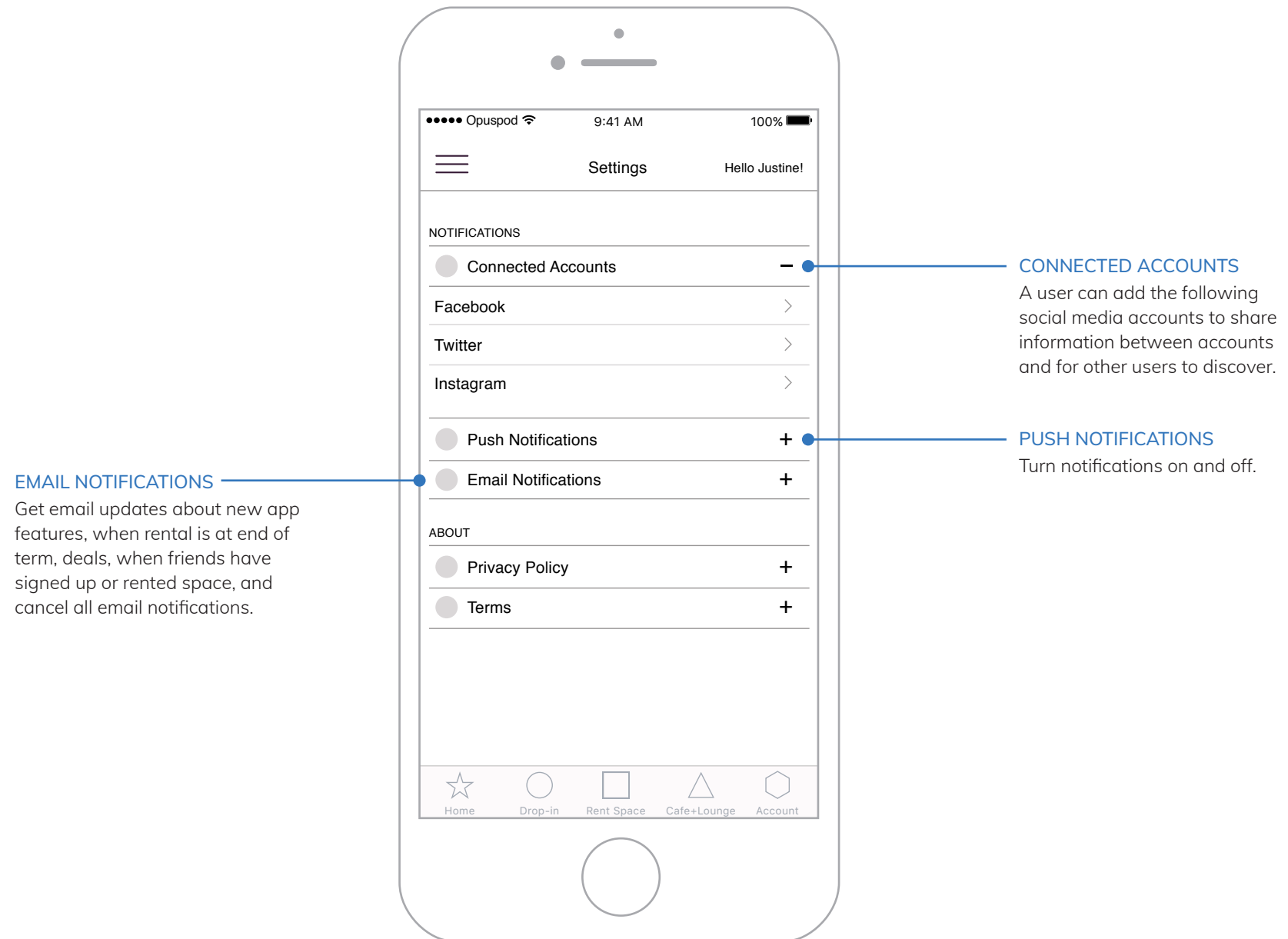

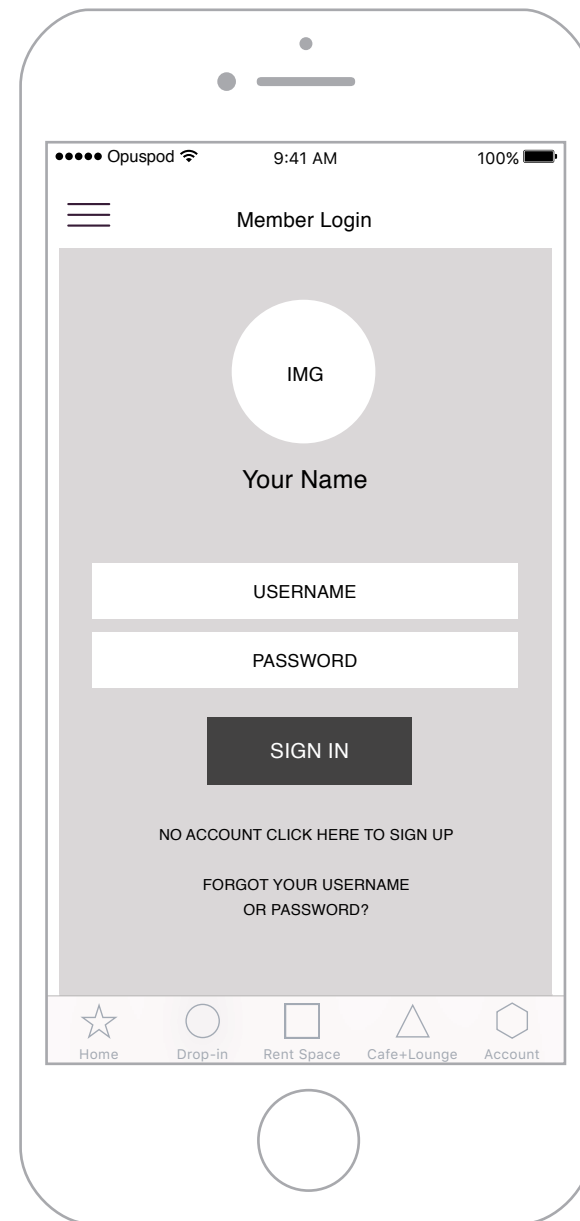

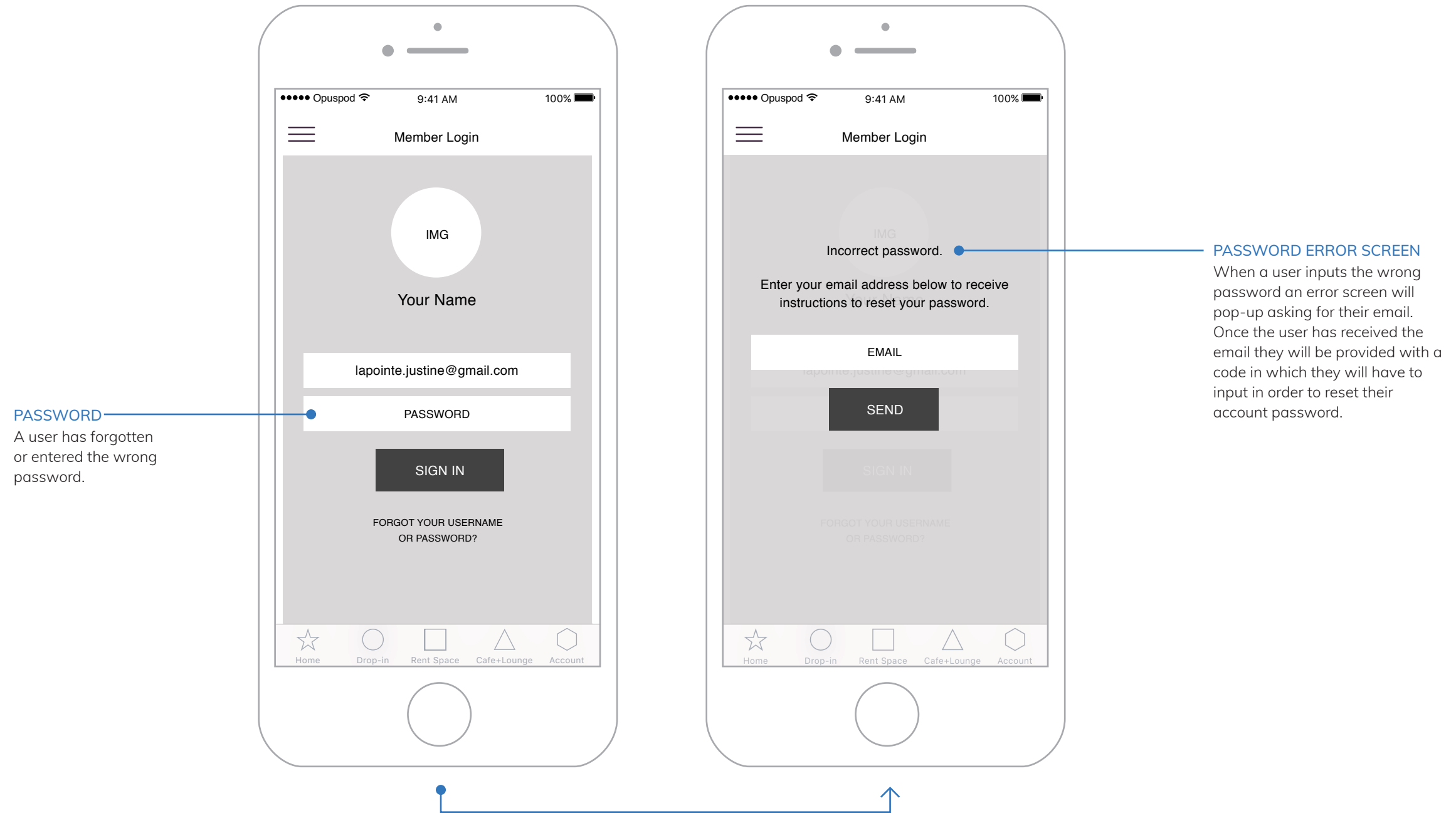

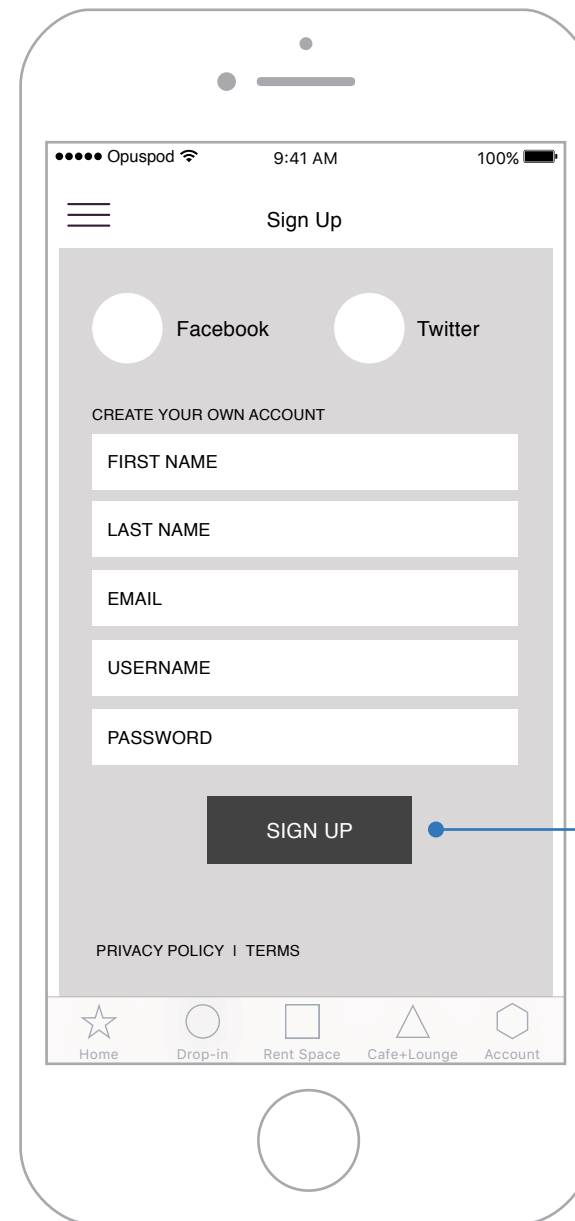

SIGN UP

If a user doesn't have an account they can choose to create an account through the 'Sign Up' page. A user can sign up using their Facebook or Twitter account.

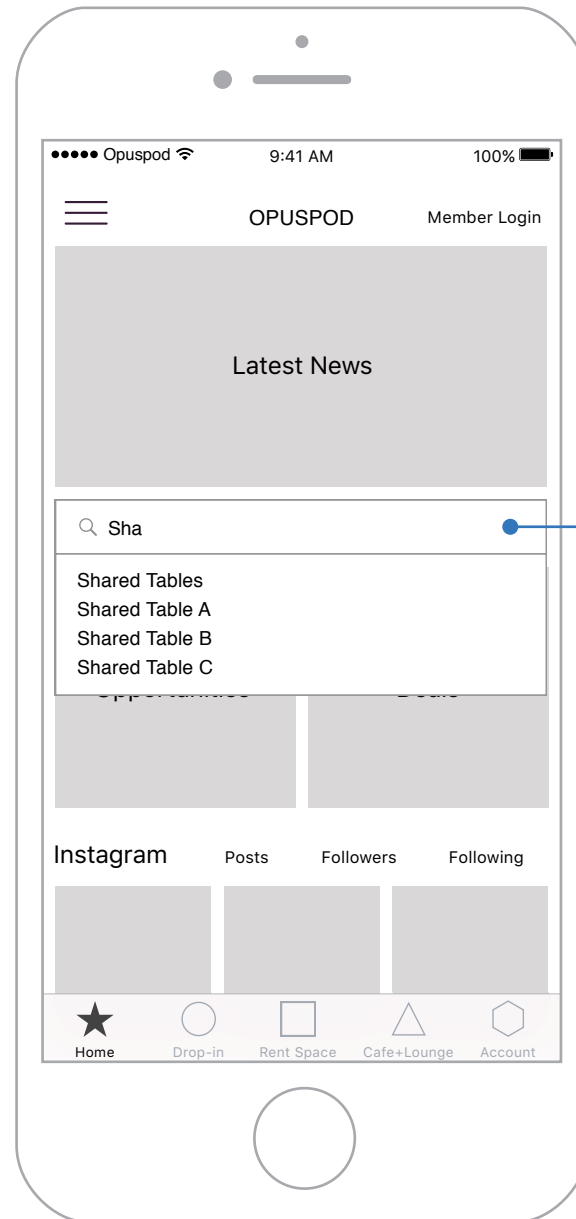

LIVE SEARCH

Live search is activated after the first three letters of a word are typed. Cached items are stored making searching easier.

